



## ENHANCE YOUR ROOFLINE.

Shasta HD Ridge features SBS modified asphalt and a pre-folded design for ease of application. It is available in 8" and 10" widths, and is made to complement our most popular shingle colors with its bold profile. Enhance your roofline with high definition Shasta HD Ridge. Color shown: Shore Wood



**PABCO® Roofing Products**  
*Exceptional People. Remarkable Products.®*

## COLOR COMPATIBILITY CHART

Shasta HD Ridge Colors	PABCO Roofing Shingle Colors
Autumn Brown ♦	Oakwood, Barkwood
Birch Bark ♦	Weathered White
Granite Gray ♦	Pewter Gray, Granite
Hearth Wood	Prairie Wood
Hunter Green ♦	Sherwood Green
Midnight Black ♦	Antique Black, Charcoal
Ponderosa	Buckskin Tan
Rocky Beach ♦	Rocky Beach, Weathered Wood HD, Weathered Wood SW
Rustic Wood ♦	Rustic Brown, Harvest Brown
Sage Gray	Driftwood, Beach Wood
Shore Wood	Weathered Wood

## FEATURES

- SBS Modified
- Available in 8" or 10" width
- 1 carton covers 20 lineal feet

## TECHNICAL INFORMATION

### UL Classified To Meet:

- ASTM D3161 Class A, Wind Resistance Standard
- UL 790 Class A, Fire Resistance Standard

### Complies With:

- ASTM D3462

Available with



Helps resist black streaks caused by algae.  
\*\*Not available in all markets.

♦ Color available with Algae Defender™

## INSTALLATION INSTRUCTIONS

Shasta HD Ridge's adjustable design eliminates the need for hand bending, flexing, opening or closing of the unit. Simply remove unit from carton and place on ridge as is. Then follow instructions as shown below.

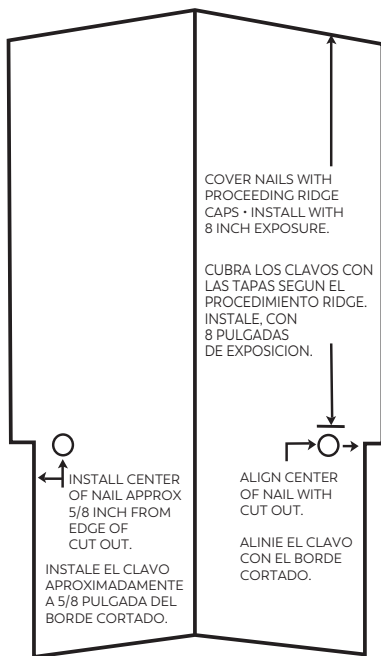

### EXPOSURE EXPOSICIÓN

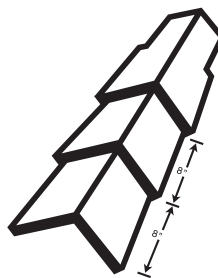

## INSTRUCCIONES DE INSTALACIÓN

El diseño ajustable de Shasta HD Ridge elimina la necesidad de doblar la mano o flexionarla, abrir o cerrar la unidad. Simplemente retire la unidad del carton y colóquela en el caballete como esté. Luego siga las instrucciones como se muestra abajo.

### FASTENERS

#### METHOD 1

(NAILING WITHOUT EXPOSED NAILS)

- INSTALL ALL NAILS AS SHOWN IN SKETCH
- USE LARGE HEAD ROOFING NAILS SUFFICIENT TO PROPERLY PENETRATE ROOF SHEETING
- INSTALL RIDGES WITH 8" EXPOSURE

### SUGETADORES

#### METODO 1

(CLAVADO SIN EXPONER LOS CLAVOS)

- INSTALE LOS CLAVOS COMO SE MUESTRA EN EL DIBUJO.
- USE CLAVOS PARA TECHO DE CABEZA GRANDE APROPIADOS PARA PENETRAR LAS HOJAS DEL TECHO
- INSTALE EL RIDGE EXPUESTO A 8" PULGADAS

#### METHOD 2

(EXPOSED NAILING)

- INSTALL NAILS ONE INCH BACK FROM FRONT EDGE
- USE A 6# OR 7# TYPE GALVANIZED NAIL SUFFICIENT IN LENGTH TO PROPERLY PENETRATE THE ROOF SHEETING

**NOTE:**  
FOR OPTIMUM APPEARANCE DO NOT USE LARGE HEAD ROOFING NAILS

#### METODO 2

(CLAVOS EXPUESTOS)

- INSTALE LOS CLAVOS A UNA PULGADA DE DISTANCIA DEL BORDE FRONTAL
- USE CLAVOS NUMEROS 6 O 7 TIPO GALVANIZADO SUFICIENTEMENTE LARGOS PARA PENETRAR LAS HOJAS DEL TECHO

**NOTA:**  
PARA UNA APARIENCIA OPTIMA NO UTILIZE CLAVOS PARA TECHO DE CABEZA GRANDE

### GABLE INSTALLTION - OPTIONAL INSTALACIÓN DEL AGUILON - OPCIONAL

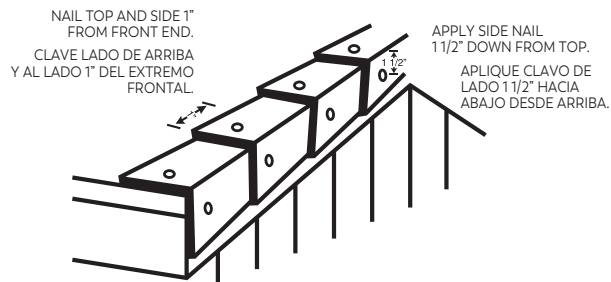

1476 Thorne Road, Tacoma, WA 98421  
253.272.0374 www.pabcoroofing.com